

T Ferrules

Code	Dimensions (mm)			
	A	B	C	D
HT2TF	18.5	9.5	2.4	3.9
HT4TF	21.0	10.0	2.8	4.7
HT6TF	32.0	15.0	3.4	5.3
HT10TF	44.0	20.0	4.4	6.3
HT16TF	56.0	25.0	5.5	7.6
HT25TF	70.0	30.0	6.9	9.0
HT35TF	74.0	32.0	8.2	10.7
HT50TF	78.0	34.0	10.0	12.8
HT70TF	86.0	36.0	11.7	15.0
HT95TF	94.0	38.0	13.5	17.4
HT120TF	105.0	40.0	15.5	19.8

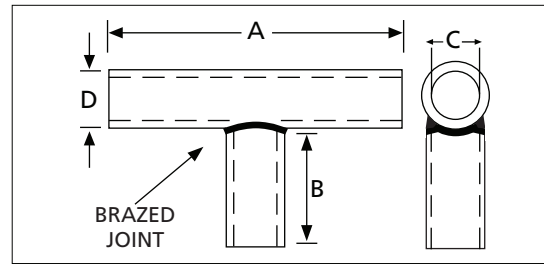

Random samples submitted to the SABS complied with SABS IEC61238-1:1993 and the relevant test report is freely available upon request.

The test report relates only to the items submitted for the actual test and it furnishes or implies no guarantee whatsoever in respect of similar items that have not been tested. The performance of the test and the issue of the test report do not imply approval by the SABS of the quality and/or performance of the items that have been tested but signifies that the items tested met the requirements of SABS IEC61238-1:1993.
RCC NO: 0902175

HT Pin Terminals

Code	Size (mm)	Dimensions (mm)					
		A	B	C	D	L	W
HTPTNB513	6	3.4	5.6	6.0	14.0	20.0	2.8
HTPTNB10121	10	4.5	6.9	8.0	14.0	22.0	4.3
HTPTNB1613	16	5.8	8.4	10.0	16.0	26.0	5.5
HTPTNB2515	25	7.0	9.5	13.5	20.0	33.5	6.8
HTPTNB3520	35	8.4	11.8	16.0	24.5	40.5	8.0
HTPTNB5012	50	9.6	13.6	19.0	26.0	45.0	9.5
HTPTNB7025	70	11.4	15.8	24.0	31.0	55.0	11.0
HTPTNB9525	95	13.5	18.9	24.0	31.0	55.0	12.5

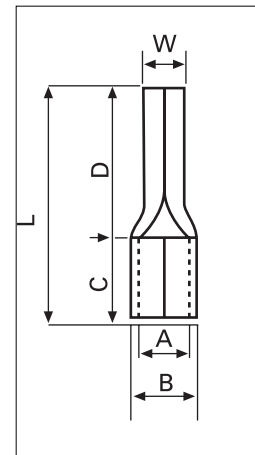

HTB Lug Kit

- Robust metal boxes for harsh environments
- Lockable and secure with no mixing when transported
- Large selection available
- Identifiable markings for easy reference and replenishment
- Boxes and cups available separately
- Flexibility, use catalogue and make up your own kit

Selection Chart

Code	Quantity of Each Component	Content	
HTBK1 HTB Lug kit	100/80/50/40/25	HTB14, 15, 16 24, 25, 1F, 2F, 26, 45, 4F, 46, 64, 65, 66, 6F, 68, 105, 106, 10F, 108, 166, 168, 1610, 16F	