

## XLPE Lugs

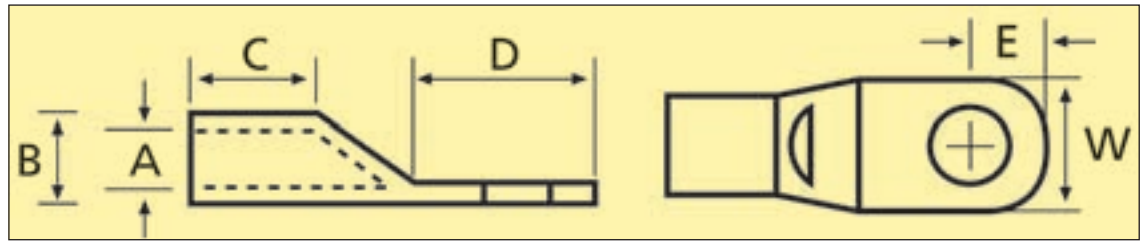

Technical Table

| Cable<br>Size<br>(mm <sup>2</sup> ) | Stud<br>(mm) | Code      | Dimensions (mm) |         |                |             |             |                  |            |
|-------------------------------------|--------------|-----------|-----------------|---------|----------------|-------------|-------------|------------------|------------|
|                                     |              |           | Barrel          |         |                | Spade       |             |                  |            |
|                                     |              |           | A<br>ID         | B<br>OD | t<br>Thickness | C<br>Length | D<br>Length | E<br>Hole to End | W<br>Width |
| 35                                  | 8            | HTX35-8   | 7.3             | 10.5    | 2.0            | 16.0        | 24.0        | 11.0             | 19.0       |
|                                     | 10           | HTX35-10  | ↓               | ↓       | ↓              | ↓           | ↓           | ↓                | ↓          |
|                                     | 13           | HTX35-12  | ↓               | ↓       | ↓              | ↓           | ↓           | ↓                | ↓          |
| 50                                  | 8            | HTX50-8   | 8.8             | 12.3    | 3.0            | 20.0        | 24.0        | 11.0             | 19.0       |
|                                     | 10           | HTX50-10  | ↓               | ↓       | ↓              | ↓           | ↓           | ↓                | ↓          |
|                                     | 12           | HTX50-12  | ↓               | ↓       | ↓              | ↓           | ↓           | ↓                | ↓          |
| 70                                  | 10           | HTX70-10  | 10.4            | 14.6    | 4.2            | 21.0        | 27.0        | 12.0             | 20.0       |
|                                     | 12           | HTX70-12  | ↓               | ↓       | ↓              | ↓           | ↓           | ↓                | ↓          |
| 95                                  | 10           | HTX95-10  | 12.1            | 17.0    | 4.7            | 24.0        | 28.0        | 13.0             | 24.0       |
|                                     | 12           | HTX95-12  | ↓               | ↓       | ↓              | ↓           | ↓           | ↓                | ↓          |
| 120                                 | 12           | HTX120-12 | 14.0            | 19.1    | 5.0            | 26.0        | 18.0        | 1.30             | 26.0       |
| 150                                 | 12           | HTX150-12 | 15.3            | 21.3    | 5.8            | 31.0        | 37.0        | 15.0             | 30.0       |
| 185                                 | 12           | HTX185-12 | 17.0            | 23.7    | 6.4            | 34.0        | 40.0        | 16.0             | 33.0       |
| 240                                 | 12           | HTX240-12 | 20.0            | 27.1    | 7.2            | 34.0        | 41.0        | 16.0             | 37.0       |
| 300                                 | 12           | HTX300-12 | 21.6            | 30.5    | 9.0            | 38.0        | 48.0        | 16.0             | 42.0       |
| 400                                 | 16           | HTX400-16 | 24.5            | 34.6    | 10.2           | 51.0        | 49.0        | 21.0             | 48.0       |
| 500                                 | 16           | HTX500-16 | 28.5            | 38.9    | 10.5           | 51.0        | 52.0        | 25.0             | 54.0       |
| 630                                 | 16           | HTX630-16 | 33.0            | 45.0    | 12.0           | 53.0        | 65.0        | 28.0             | 64.0       |

## XLPE Ferrules

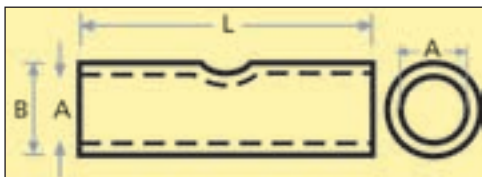

Random samples submitted to the SABS complied with SABS IEC61238-1:1993 and the relevant test report is freely available upon request.

The test report relates only to the items submitted for the actual test and it furnishes or implies no guarantee whatsoever in respect of similar items that have not been tested. The performance of the test and the issue of the test report do not imply approval by the SABS of the quality and/or performance of the items that have been tested but signifies that the items tested met the requirements of:

SABS IEC61238 / Authorisation No: 0902175.

Technical Table

| Cable<br>Size<br>(mm <sup>2</sup> ) | Code    | Dimensions |         |             |
|-------------------------------------|---------|------------|---------|-------------|
|                                     |         | A<br>I.D   | B<br>OD | L<br>Length |
| 35                                  | HTFX35  | 7.3        | 10.5    | 38.0        |
| 50                                  | HTFX50  | 8.8        | 12.3    | 42.0        |
| 70                                  | HTFX70  | 10.4       | 14.6    | 43.0        |
| 95                                  | HTFX95  | 12.1       | 17.0    | 45.0        |
| 120                                 | HTFX120 | 14.0       | 19.1    | 55.0        |
| 150                                 | HTFX150 | 15.3       | 21.3    | 58.0        |
| 185                                 | HTFX185 | 17.0       | 23.7    | 64.0        |
| 240                                 | HTFX240 | 20.0       | 27.1    | 70.0        |
| 300                                 | HTFX300 | 21.6       | 30.5    | 75.0        |
| 400                                 | HTFX400 | 24.5       | 34.6    | 80.0        |
| 500                                 | HTFX500 | 28.5       | 38.9    | 90.0        |
| 630                                 | HTFX630 | 33.0       | 45.0    | 100.0       |